



◆ Model number

SGP2 - 36 F 1 H 1 - L XXX

① ② ③ ④ ⑤ ⑥ ⑦ ⑧ ⑨

- | | | | |
|---|---|---|---|
| <p>① Series number
SGP2 series</p> <p>② Mounting spigot diameter
- : $\phi 82_{-0.036}^{-0.036}$ Z : $\phi 102_{-0.036}^{-0.036}$
A : $\phi 82.55_{-0.05}^{-0.05}$ B : $\phi 101.6_{-0.05}^{-0.05}$</p> <p>③ Size</p> | <p>④ Position of ports
F : rear cover side ports
D : rear ports</p> <p>⑤ Port configuration
1 : flange port (sides only)
2 : G screw thread</p> | <p>⑥ Mounting
H : horizontal 2 bolts</p> <p>⑦ Shaft end
1 : SAE Spline 13 teeth</p> | <p>⑧ Rotation viewing from shaft end
L = counterclockwise
R = clockwise</p> <p>⑨ Code number in 3 figures</p> |
|---|---|---|---|

◆ Specifications

Size	Displacement		Rated pressure			Max. peak pressure			Speed min ⁻¹		Inlet pressure	Mass		
	cm ³	in ³	MPa	bar	psi	MPa	bar	psi	MIN.	MAX.		kg	lb	
20	20.3	1.238	24.5	245	3553	29.4	294	4263	400	3000	bar -0.20~2.0	4.9 (4.4)	10.78 (9.68)	
23	23.3	1.421										5.1 (4.6)	11.22 (10.12)	
25	25.3	1.543										5.3 (4.8)	11.66 (10.56)	
27	27.4	1.671										5.4 (4.9)	11.88 (10.78)	
32	32.5	1.983										5.7 (5.1)	12.54 (11.22)	
36	36.5	2.227										5.9 (5.3)	12.98 (11.66)	
40	40.6	2.477	22.6	226	3277	27.5	275	3988		3000 (2500)	MPa -0.02~0.2	6.1 (5.4)	13.42 (11.88)	
44	44.7	2.727	20.6	206	2987	24.5	245	3553		2500 (2300)		6.3 (5.6)	13.86 (12.32)	
48	48.7	2.970	18.6	186	2697	22.6	226	3277		2300 (2300)		psi -2.9 ~29	6.6 (5.9)	14.52 (12.98)
52	52.8	3.221	17.2	172	2494	20.6	206	2987		2300 (2000)			6.8 (6.1)	14.96 (13.42)
										2200 (2000)				

NOTE : () Rear Ports

◆ Typical assembly

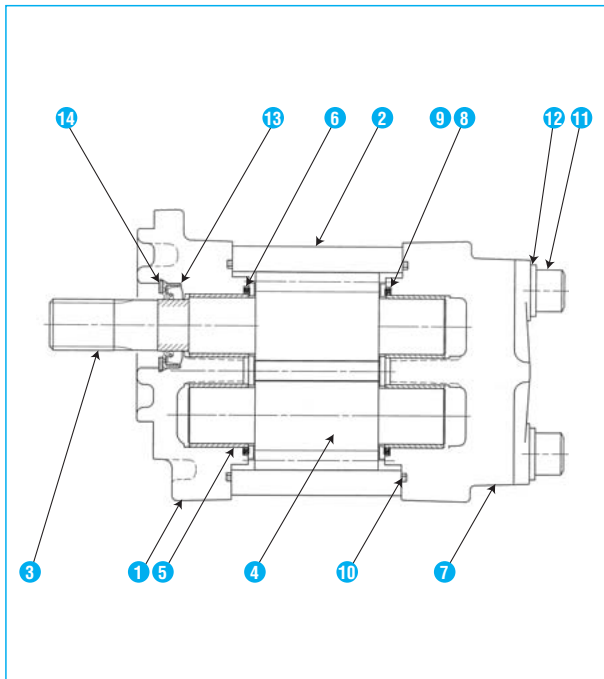

Item No.	Name	QTY	Material
①	Front cover	1	Aluminum alloy
②	Body	1	Cast iron
③	Drive gear	1	Alloy steel
④	Driven gear	1	Alloy steel
⑤	Bush	4	Special alloy steel
⑥	Side plate	2	Special alloy steel
⑦	Rear cover	1	Aluminum alloy
⑧	Back-up	2	Synthetic resin
⑨	Gasket	2	Nitrile rubber
⑩	Gasket	2	Nitrile rubber
⑪	Bolt	4	Alloy steel
⑫	Washer	4	Carbon steel
⑬	Oil seal	1	Nitrile rubber
⑭	Retainer ring	1	Carbon tool steel

NOTES : "QTY" shows the amount per one

◆ Outline dimensions

dimensions in mm

SGP2_A□F1H□-LXXX (Side ports)

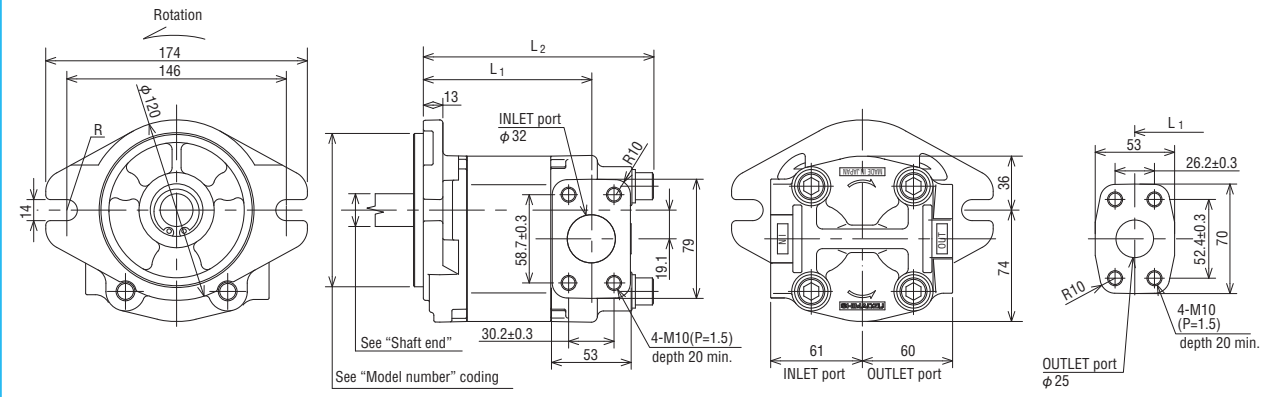

SGP2_A□D2H□-LXXX (Rear ports)

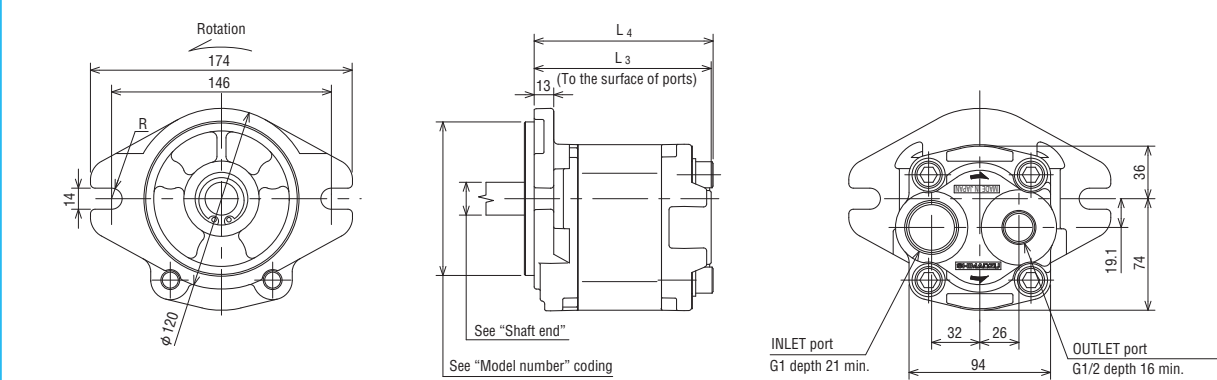

- NOTE 1. Figure shown indicated counterclockwise rotation "L" viewing from shaft end. Clockwise rotation "R" is mirror image of this.
2. Unless otherwise specified, tolerance on dimension are ±1.0 mm.

Size	Side ports		Rear ports	
	L ₁	L ₂	L ₃	L ₄
20	95.6	138	101.6	104
23	98.6	141	104.6	107
25	100.6	143	106.6	109
27	102.6	145	108.6	111
32	107.6	150	113.6	116
36	111.6	154	117.6	120
40	115.6	158	121.6	124
44	119.6	162	125.6	128
48	123.6	166	129.6	132
52	127.6	170	133.6	136

● Shaft end

SAE Spline (Some dimensions are different form SAE standard.)

SAE Spline 13 teeth

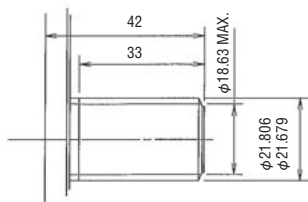

No. of tooth : 13
D.P. : 16/32
Pressure angle : 30°
Over pin dia. : 24.891~
24.819
Pin dia. : φ3.048

SGP2 Series Performance curves

OIL: ISO VG32 Hydraulic Fluid at 40°C

SGP2-20

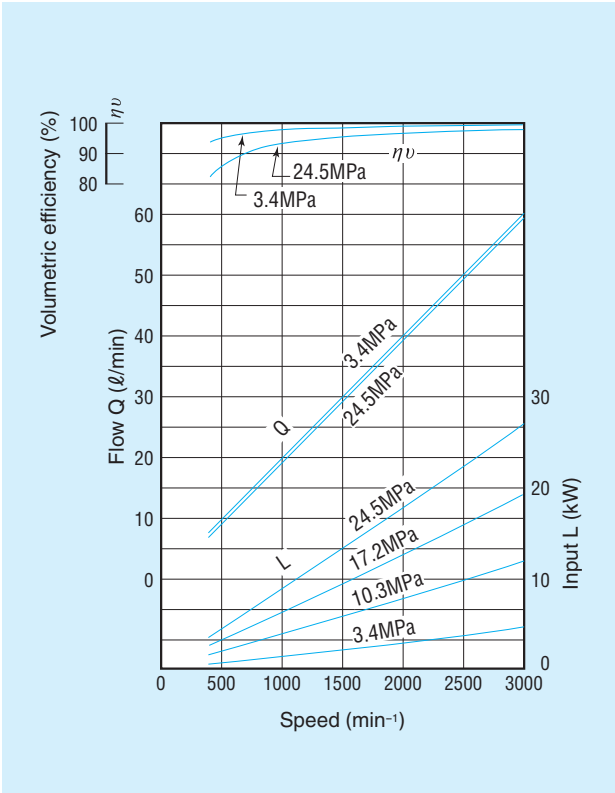

SGP2-23

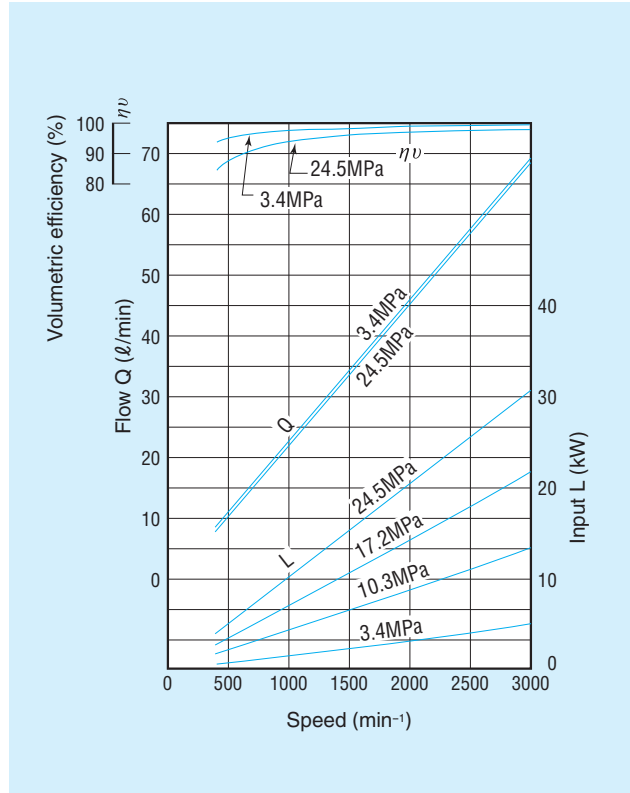

SGP2-25

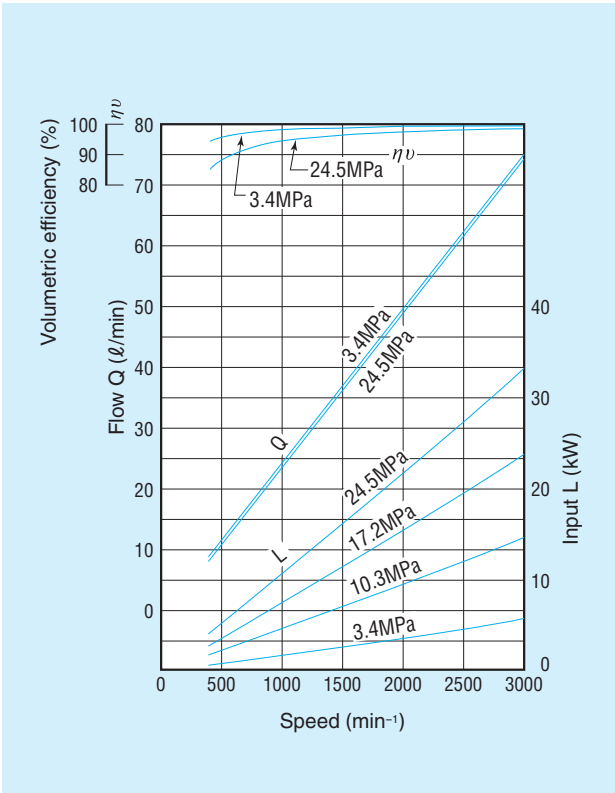

SGP2-27

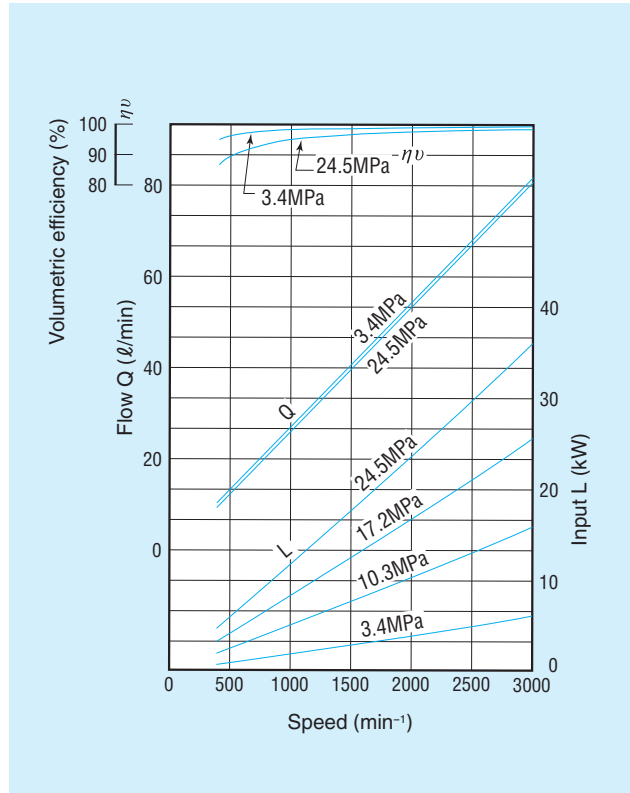

SGP2 Series Performance curves

OIL: ISO VG32 Hydraulic Fluid at 40°C

SGP2-32

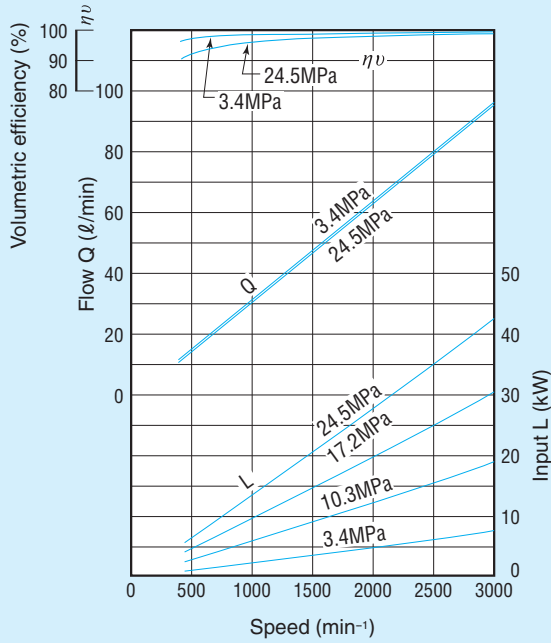

SGP2-36

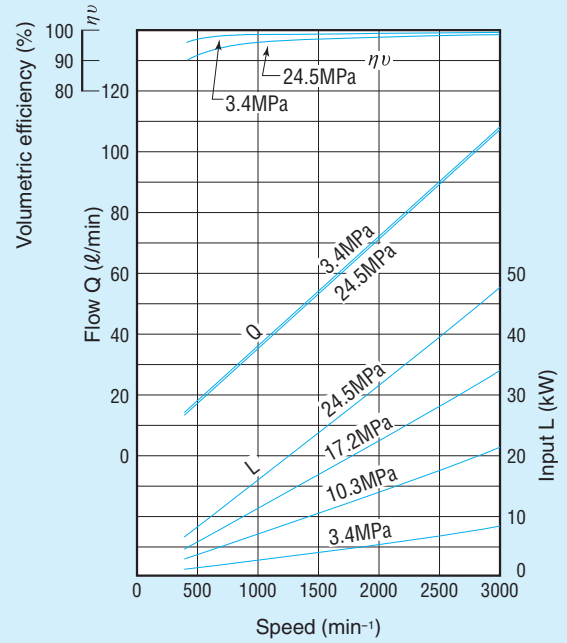

SGP2-40

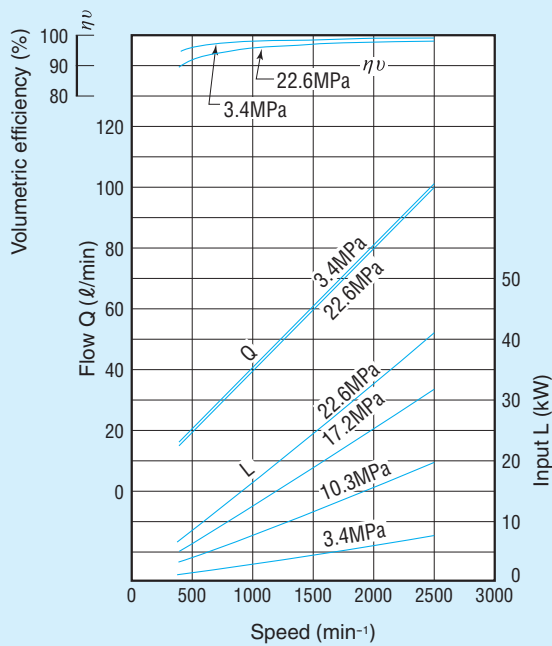

SGP2-44

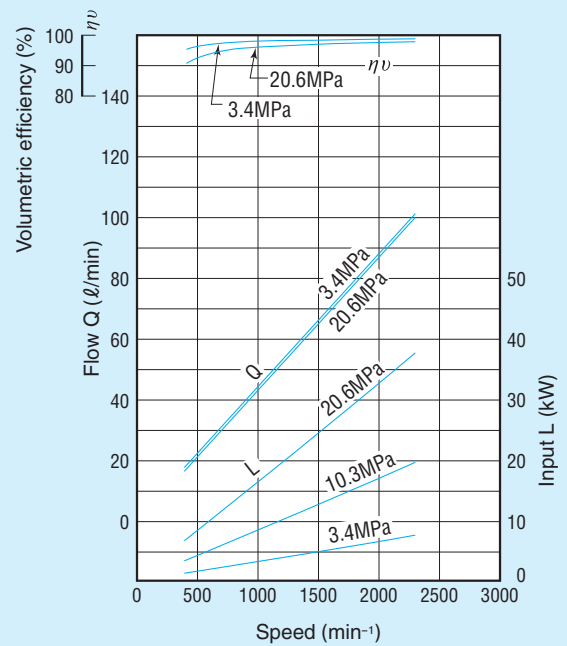

SGP2 Series Performance curves

OIL: ISO VG32 Hydraulic Fluid at 40°C

SGP2-48

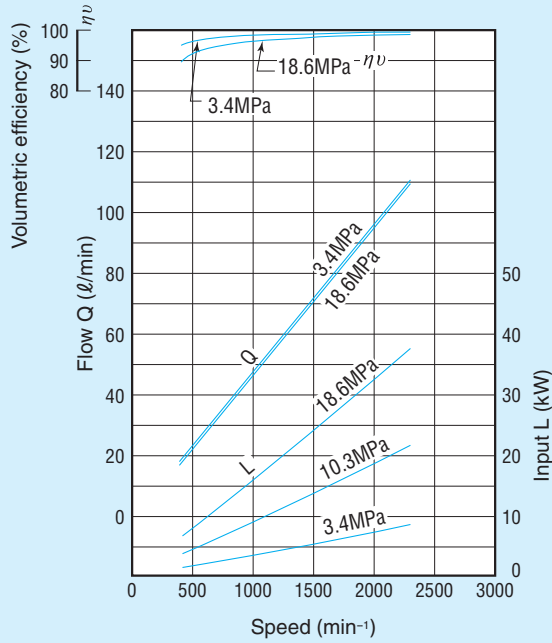

SGP2-52

